

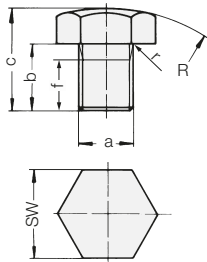

Contact Bolts for block cylinders



Contact bolts, dome head, flame-hardened

for nom. cyl. Ø D	a	b	c	f	R	r	SW	Part no.
12	M 5	9	19	7	20	0.3	8	3614-027
16	M 6	10	20	8	20	0.3	10	3614-016
12/16	M 6	6	9.5	5	20	0.3	10	• 3614-039
25	M 8	10	20	8	20	0.3	11	3614-001
25	M 10	12	22	9.5	35	0.3	17	3614-002
20/25	M 8	8	13	6	25	0.3	13	• 3614-038
32/40	M 12	12	22	9	45	0.3	19	3614-028
40	M 16	20	30	16	60	0.3	24	3614-003
50	M 20	25	35	20	60	0.3	30	3614-015
63	M 27	30	47	24	100	0.3	41	3614-017
80	M 30	35	54	29	100	0.3	46	3614-018
100	M 42	45	71	38	140	0.3	65	3614-019
125	M 48	60	90	50	250	1.6	75	3614-020

• not hardened for threaded-body cylinders B 1.460 and B 1.461

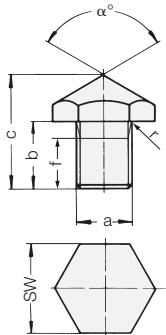

Contact bolts, cone head, flame-hardened

for nom. cyl. Ø D	a	b	c	f	α°	r	SW	Part no.
12	M 5	9	16	7	120	0.3	8	3614-033
12/16	M 6	6	18	4	90	0.3	10	* 3614-068
16	M 6	10	22	8	90	0.3	10	3614-032
20/25	M 8	8	22	6	90	0.3	13	3614-069
25	M 10	12	27	9.5	90	0.3	17	3614-021
32	M 12	12	25	8	120	0.3	19	3614-031
40	M 16	20	35	16	120	0.3	24	3614-022
50	M 20	25	40	20	120	0.3	30	3614-023

* for threaded-body cylinders B 1.460 and B 1.461

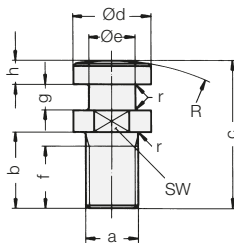

Contact bolts with coupling pins, hardened and tempered, max. operating pressure for pull-type block cylinders 350 bar

for nom. cyl. Ø D	a	b	c	Ød	Øe	f	g	h	r	R	SW	Part no.
25	M 10	14.5	32	20	10	12	6.5	5.5	0.8	320	17	3614-070
32	M 12	14.5	32	20	10	12	6.5	5.5	1	320	17	3614-091
40	M 16	20	40	25	14	16	7	6	1.2	400	22	3614-236
50	M 20	28	56	33.2	17	22	10	10	1	500	27	3614-237
63	M 27	39	75	40	23	32	13	12	1.2	630	36	3614-065
80	M 30	35	89	52	28	27	19	19	1	800	46	3614-066

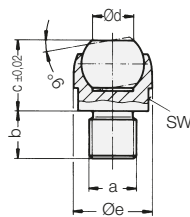

Swivel contact bolt, flat face

max. load [kN]	for nom. cyl. Ø D	a	b	c ± 0,02	Ød	Øe	SW	Part no.
10	12/16	M 6	6	13	7.2	13	11	3614-228
10	20/25	M 8	8	13	7.2	13	11	3614-072
25	25	M10	10	18	10.5	20	17	3614-073
25	32/40	M12	12	18	10.5	20	17	3614-074
90	40	M16	16	27	20	30	27	3614-075

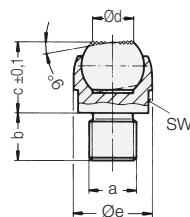

Swivel contact bolt, serrated face

max. load [kN]	for nom. cyl. Ø D	a	b	c ± 0,1	Ød	Øe	SW	Part no.
10	20/25	M 8	8	13	7,2	13	11	3614-131
25	25	M10	10	18	10,5	20	17	3614-194
25	32/40	M12	12	18	10,5	20	17	3614-118
90	40	M16	16	27	20	30	27	3614-119